

## Instructions for Set-up Stand with Arbor or Collet

**Note: Instructions are for a set-up stand with a typical arbor and tool. The arbor and tool shown may not look identical to your arbor and tool.**

The set-up stand and arbors are designed to hold shaper cutters, moulders, etc. when changing inserts. The set-up stand is a solid stand that holds the cutting tool, yet allows the tool to rotate for easy, convenient, and safe replacement of inserts.

1. Great Lakes Custom Tool recommends the **use of safety glasses at all times.**
2. When the cutter is mounted on the machine, be sure to follow **Lock Out/Tag Out** procedures and use all appropriate personal protection equipment.

### Set-Up Stand Assembly and Use

1. The set-up stand (**Part No. 955-07584-0000**) consists of an angle plate stand, adjustable handle and a collar. A typical arbor assembly consists of an arbor and a shaft collar. (See back of page for a list of additional arbor assemblies, and collets)
2. Bolt or securely fasten the set-up stand onto a sturdy table or work bench.
3. Slide arbor into hole in face of set-up stand and install collar (washer) and adjustable handle as shown. Turn the handle clockwise (cw) to tighten. The handle has a ratchet type action. When facing the handle, pull back on the handle, this slides the handle axially towards you. While holding the handle out towards you, rotate the handle counter-clockwise (ccw) and then release the pressure. The handle will snap back into position. The handle can then be rotated clockwise to continue tightening.
4. Slide cutter onto arbor. Install the split shaft collar onto arbor and tighten the screw. This will prevent the cutter from slipping off the arbor while replacing the inserts.
5. Remove inserts, clean cutter body and replace inserts with resharpened inserts or with new inserts.

4. Remove inserts, clean cutter body and replace inserts with resharpened inserts or with new inserts.

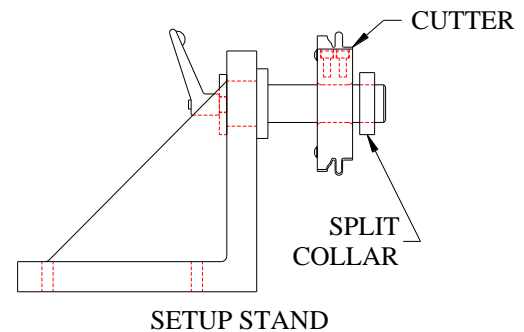
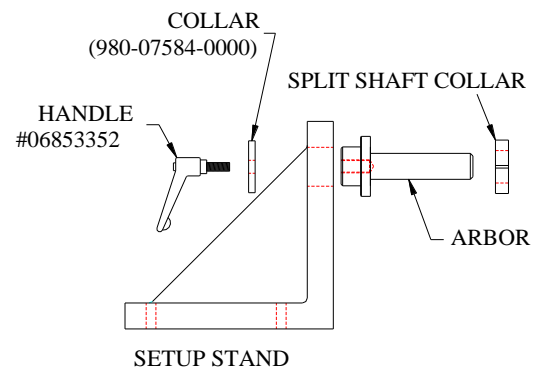

### Set-Up Stand Assembly with Collet Holder

The collet holder mounts to the set-up stand and is used to hold router bits when changing inserts.

1. Bolt or securely fasten the set-up stand onto a sturdy table or work bench.
2. Slide arbor collet into hole in face of set-up stand and install collar (washer) and adjustable handle as shown. The collets are available in sizes 1/2", 5/8", 3/4", and 1". (See page 3 for ordering information.)
3. Loosen the collet nut, insert the router bit shank and retighten the collet nut.

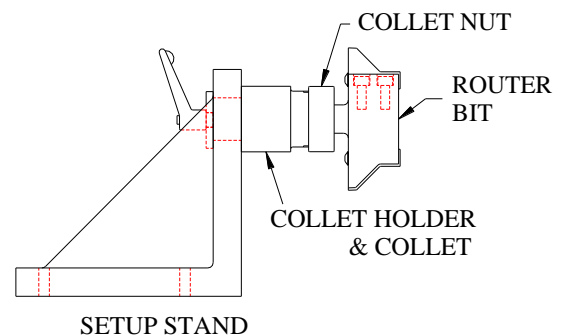

**Order Arbor Assemblies from table below**

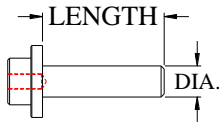

ARBOR



SHAFT COLLAR

Arbor assembly mounts to set-up stand and is used to hold shaper cutters, moulders, etc. for changing inserts. Arbor assembly includes arbor and shaft collar.

Part No.	Description	Diameter	Length
950-07584-0000	Arbor assembly	.750	100 mm
950-07584-0100	Arbor assembly	1.000	100 mm
950-07584-0200	Arbor assembly	1.250	100 mm
950-07584-0250	Arbor assembly	1.250	265 mm
950-07584-0300	Arbor assembly	1.500	100 mm
950-07584-0350	Arbor assembly	1.500	265 mm
950-07584-0360	Arbor assembly	1.750	125 mm
950-07584-0380	Arbor assembly	1.750	265 mm
950-07584-0400	Arbor assembly	1.812	100 mm
950-07584-0450	Arbor assembly	1.812	265 mm
950-07584-0500	Arbor assembly	2.125	100 mm
950-07584-0550	Arbor assembly	2.125	265 mm
950-07584-0600	Arbor assembly	30 mm	100 mm
950-07584-0650	Arbor assembly	35 mm	100 mm
950-07584-0700	Arbor assembly	40 mm	100 mm
950-07584-0750	Arbor assembly	40 mm	265 mm
950-07584-0800	Arbor assembly	50 mm	100 mm
950-07584-0850	Arbor assembly	50 mm	265 mm
950-07584-0900	Arbor assembly	60 mm	100 mm
950-07584-0950	Arbor assembly	60 mm	265 mm

**Order Collet Holder and Collets from tables below**

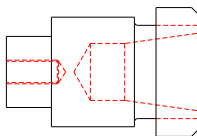

ER-40 COLLET HOLDER

ER Collet Holder mounts to set-up stand and is used to hold router bits for changing inserts. ER40 collet holder includes collet nut. **Order** proper size collet to match router bit shank.

Part No.	Description
950-07584-0990	ER40 Collet Holder

Collet Part No.	Router Bit Shank Dia.
ER40-1	1"
ER40-3/4	3/4"
ER40-5/8	5/8"
ER40-1/2	1/2"